

TECHNICAL FEATURES	
External structure	Stainless steel
Cooking surface	Granite type material, quartz, ceramic, marble, dekton, lava stone. Thickness required / thickness: between 4 and 20 mm. Materialization of the middle of the fire-place at the customer's expense.
Thickness worktop	Between 4 and 20mm
Dimensions	340 x 340 x 167 mm
Power	650W
Cooking surface	Vitroc ceramic glass.
Control panel	Glass touches control with 2m power cord, plugs depend on the country. (custom power cord available until 3m)
Amp	3A
Functions	On/Off, manual power setting (+/-) control with 2 digits display
Power supply	230 V ; 208/240 V ; AC 50 - 60 Hz
Weight	8 kg kg / 17.6 lbs.
Standards	Complies with European standards for safety of electrical appliances, for EMC, for Rohs and Intertek NSF & UL standards.
Details & Options	Including a power cord, a spacer and a washable filter.

millimeters

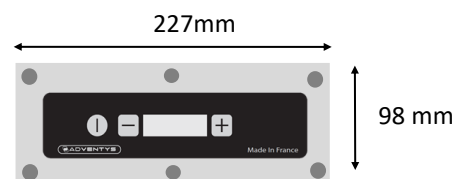
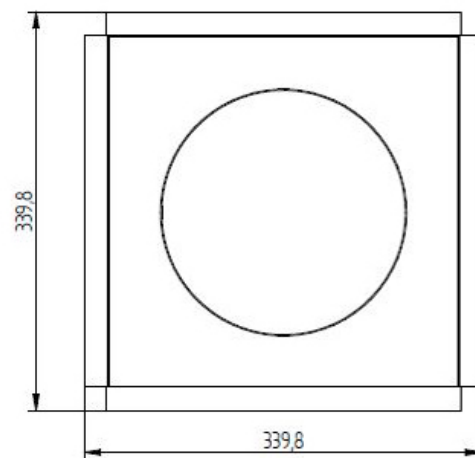
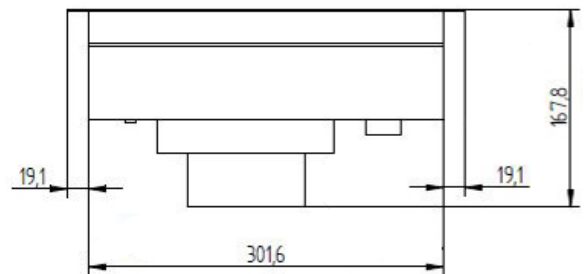

Cut out dimensions 198x68mm

ADVENTYS
Route de Pagny - 21250 Seurre - France
www.adventys.com
sales@adventys.com
T: +33 3 80 20 46 15

Important note

Adventys reserves the right to modify specifications without notice.



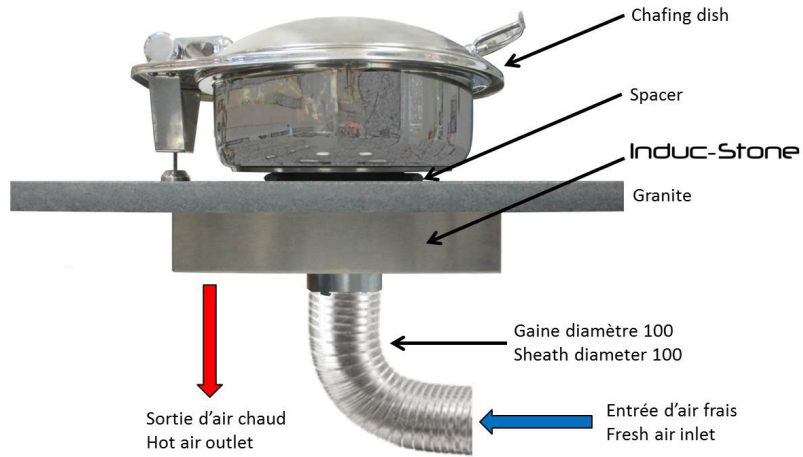

- 1: Use a material for the top of the work plan validated by ADVENTYS
Material thickness between 4 and 20 mm.
Identify the center of the home by a device of your choice.
- 2: Always position the spacer between the top and the " chafing dish "
You have to calibrate your product to obtain the temperature wished into your chafing dish.

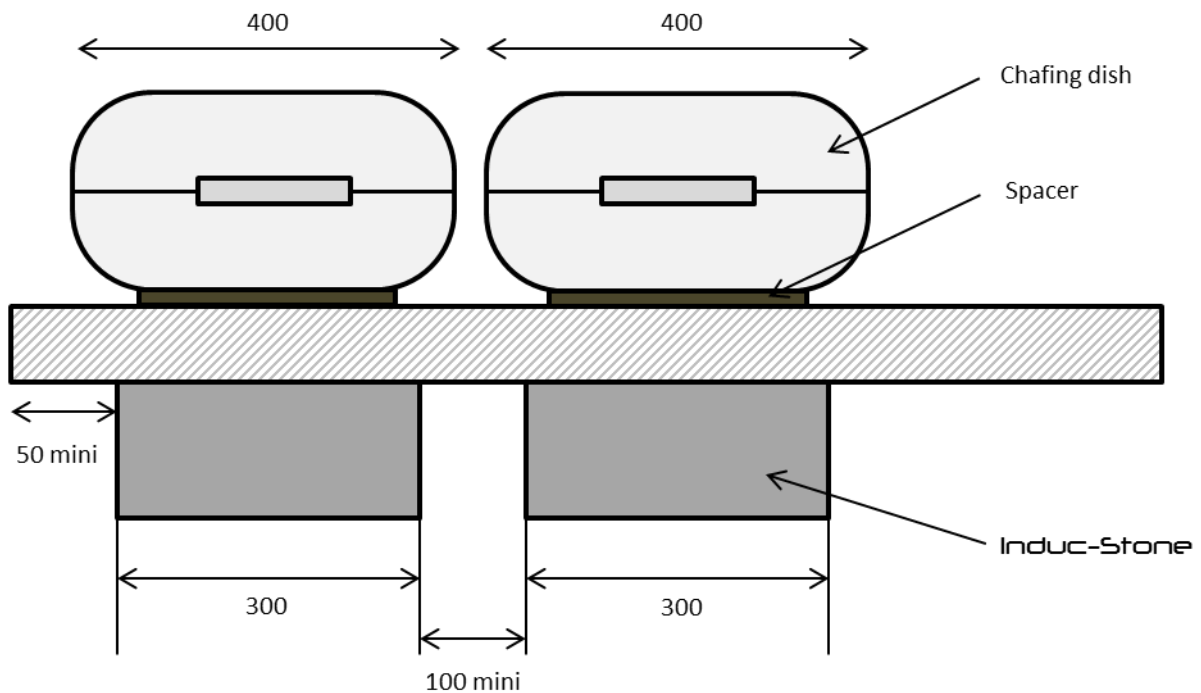

ADVENTYS
Route de Pagny - 21250 Seurre - France
www.adventys.com
sales@adventys.com
T: +33 3 80 20 46 15

Important note

Adventys reserves the right to modify specifications without notice.

Spacer :

Large spacer for large chafing dish

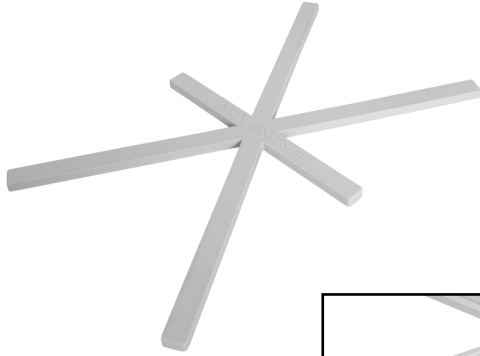

Small spacer for small chafing dish

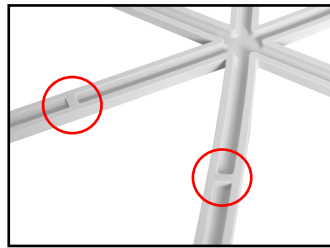
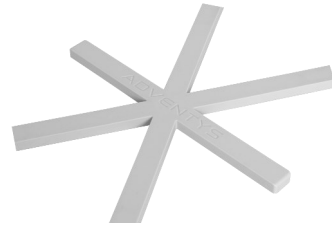

Cut your large spacer in these sections to get a small spacer.

Options :



Chafing dish rond diam 40cm



Chafing dish GN2/3



Chafing dish GN1/1

ADVENTYS
Route de Pagny - 21250 Seurre - France
www.adventys.com
sales@adventys.com
T: +33 3 80 20 46 15

Important note

Adventys reserves the right to modify specifications without notice.



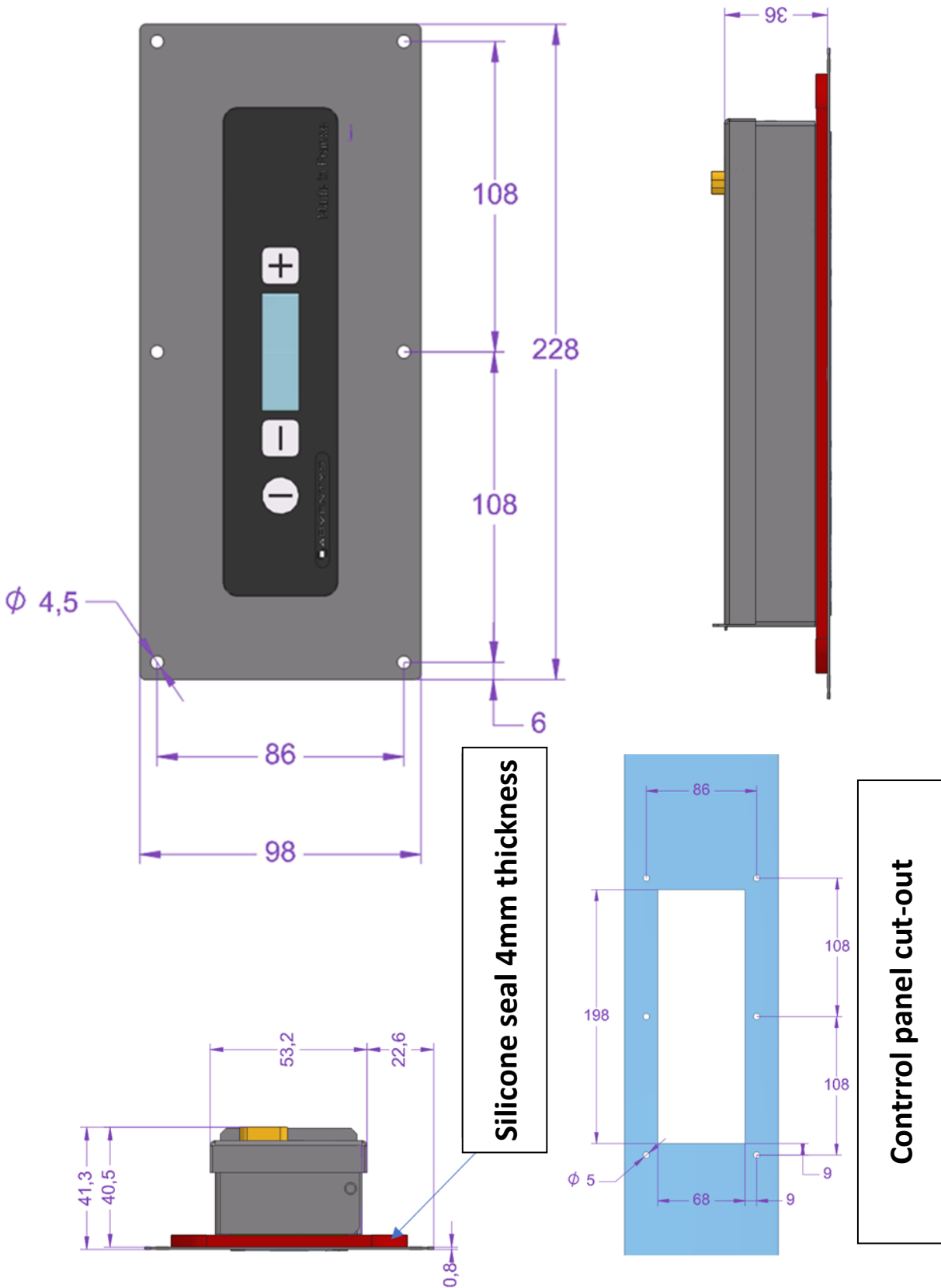

ADVENTYS
 Route de Pagny - 21250 Seurre - France
www.adventys.com
sales@adventys.com
 T: +33 3 80 20 46 15

Important note

Adventys reserves the right to modify specifications without notice.

